

KSB adjustment engine while carrying out the fuel injection pump timing procedure.

(Fig.7.52) (Fig. A).

- Loosen the lock screw **A** (Fig.A), and slide lever **B** and rod **C** on a rest position.

This will release the pump advance lever and must be performed before carrying out the fuel injection pump timing procedure.

- Make sure that the cold start device is in the rest position (inactive).

KSB setting for correct operation

(Fig. 7.52) (Fig. B).

- Loosen the adjusting collar assembly lock screw **A**, as shown in figure **A**.

- Rotate the lever **B** in a clockwise direction, until the collar assembly **D** stops against the black plastic coating **E** on rod **C**, as shown in figure **B**. A screw driver or pry tool may be used in the slot on the top of the lever to help overcome the mechanical force of the internal spring in the pump to properly position the lever.

- Tighten the lock screw **A** (Figure B)

- The KSB device is now in the working position and will function in the smoke control mode upon initial start-up (electrical contact off), until around 30 °C (86 °F) (electrical contact on).

- The KSB device is controlled/activated by a water temperature switch in the cylinder head. It should be noted that the movement of the KSB upon engine warm-up is gradual and not instantaneous.

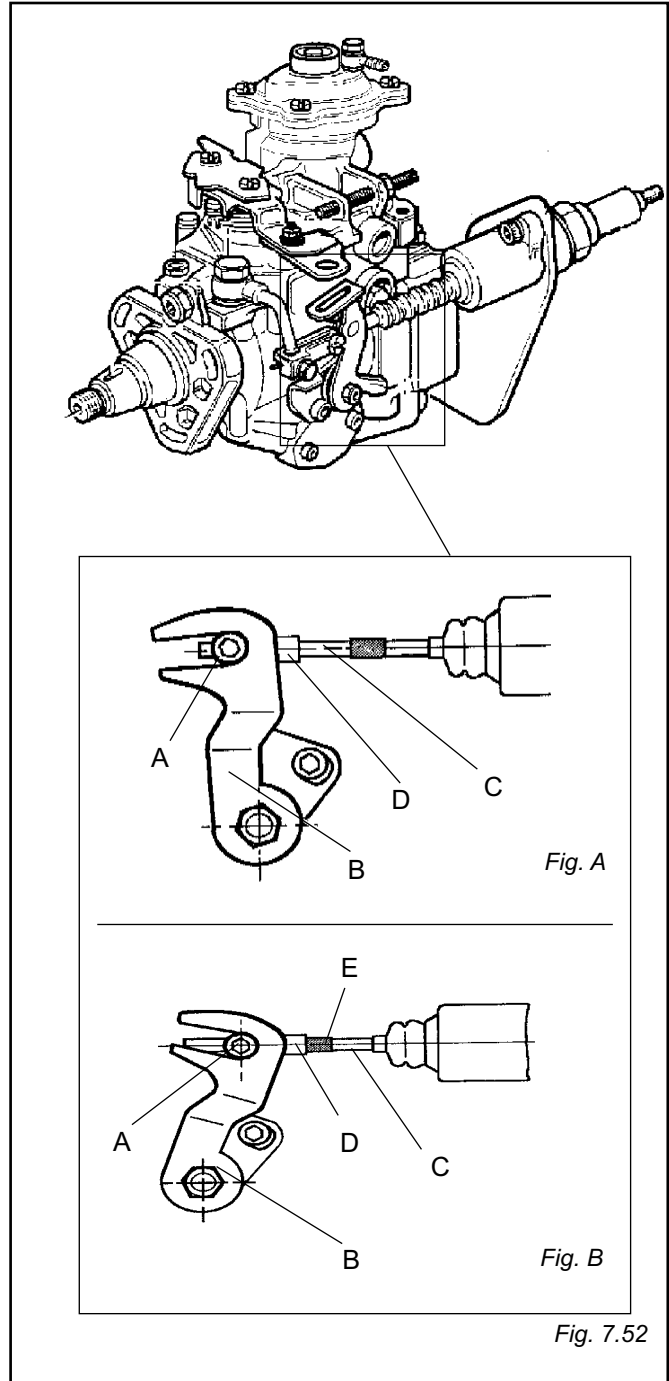

7.29 INJECTOR FUEL FEED PIPES

- Fit union **A** to the injection pump and tighten it.
- Attach fuel feed pipes **B** to the injectors **C**.

